

Diffuse sensors fiber optics

FOC 500C6Y00

dimension drawing

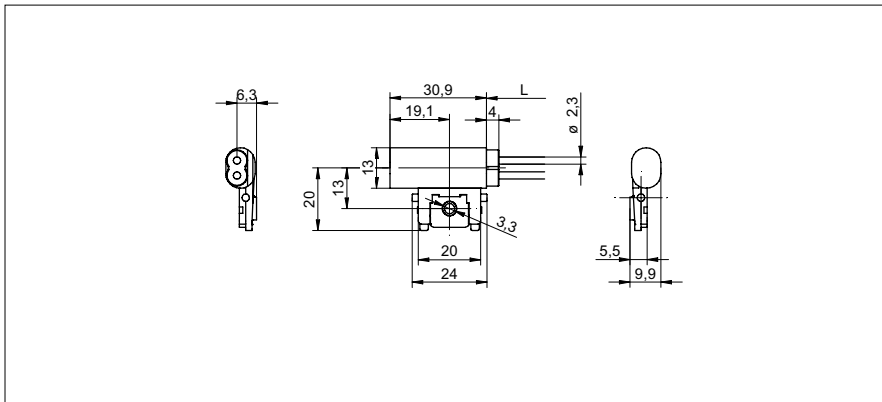

general data

type	Diffuse sensors (Leakage sensor)
measurement type	contact with medium
response time / release time	0,05 ... 5 ms
type of head (fiber optic cable)	cylindrical smooth (axial)
width / diameter (head)	13 mm
height / length (head)	30,9 mm
depth (head)	9,9 mm
material (head)	PFA
bending radius	20 mm
cable jacket diameter	2,2 mm
material cable jacket	PFA (chemically resistant)
material (fiber optic cable)	plastic
length (fiber optic cable)	5000 mm
operating temperature	-30 ... +70 °C

Sensing distance/response time:
 For the definitive sensing distance/response time please see table below "fitting fiber optic sensors".

photo



• Suitable for constrained conditions.

fitting fiber optic sensors

- FVDK 67 (standard version)
- FVDK 67 (2 adjustable outputs)
- FVDK 67 (master/slave)
- FVDK 66 (standard version)
- FVDK 66 (master/slave)
- FVDK 22
- FVDK 12
- FVDK 12 (fast version)
- FVDK 10

- operating modes
- HS High Speed
 - FT fast
 - nL Standard
 - HP High Sensitivity