

**Overview**

- emitter
- through beam sensor
- 25 m
- pulsed red LED
- connector M12 4 pin
- -25 ... 60 °C
- IP 68/69K & proTect+



Picture similar



**Technical data**

General data		Electrical data	
Type	Through beam sensor	Current consumption max. (no load)	40 mA
Special type	Washdown design	Current consumption typ.	30 mA
Emitter / receiver	Emitter	Reverse polarity protection	Yes
Light source	Pulsed red LED	Mechanical data	
Actual range Sb	25 m	Width / diameter	20,2 mm
Nominal range Sn	40 m	Height / length	47,2 mm
Power on indication	LED green	Depth	37,7 mm
Wave length	645 nm	Type	Rectangular
Alignment optical axis	< 1°	Housing material	Stainless steel 1.4404 (V4A)
Approvals/certificates	Ecolab	Front (optics)	PMMA
Electrical data		Connection types	Connector M12 4 pin
Response time / release time	< 0,49 ms	Ambient conditions	
Voltage supply range +Vs	10 ... 30 VDC	Operating temperature	-25 ... +60 °C
		Protection class	IP 68/69K & proTect+

**Dimension drawing**

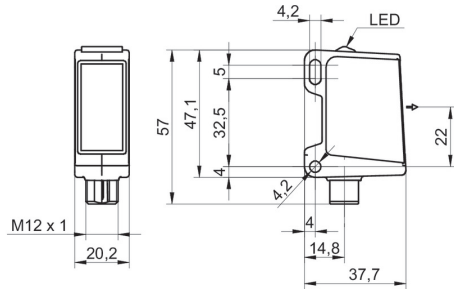

**Connection diagram**

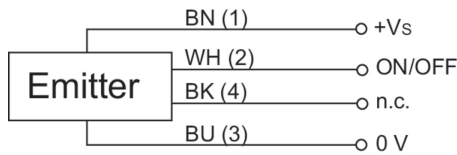

**Pin assignment**

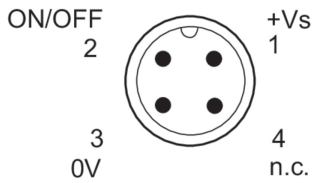

**Beam characteristic (typically)**

