

## Overview

- emitter
- through beam laser sensor
- 8 m
- pulsed red laser diode
- connector M12 4 pin
- 10 ... 50 °C
- IP 67



Picture similar



## Technical data

### General data

Type	Through beam laser sensor
Emitter / receiver	Emitter
Light source	Pulsed red laser diode
Actual range Sb	8 m
Nominal range Sn	10 m
Power on indication	LED green
Laser class	1
Distance to focus	Parallel beam
Wave length	650 nm

### Electrical data

Voltage supply range +Vs	10 ... 30 VDC
Current consumption max. (no load)	35 mA

### Electrical data

Current consumption typ.	25 mA
Reverse polarity protection	Yes

### Mechanical data

Width / diameter	14,8 mm
Height / length	43 mm
Depth	31 mm
Type	Rectangular
Housing material	Plastic (ASA, MABS)
Front (optics)	PMMA
Connection types	Connector M12 4 pin

### Ambient conditions

Operating temperature	10 ... +50 °C
Protection class	IP 67

**Dimension drawing**

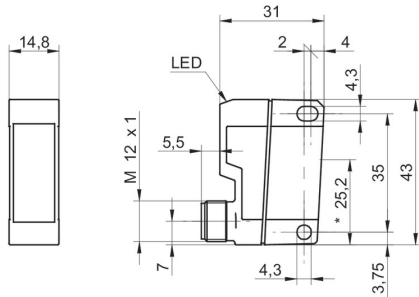

**Connection diagram**

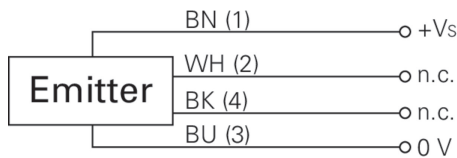

**Laser warning**

**CLASS 1 LASER  
PRODUCT**

IEC 60825-1/2014  
Complies with 21 CFR 1040.10 and  
1040.11 except for conformance with  
IEC 60825-1 Ed. 3., as described in  
Laser Notice No. 56, dated May 8, 2019

**Beam characteristic (typically)**

