

## OHDM 16P5001/S14

Diffuse sensors with background suppression - standard

Article number: 10236806

### Overview

- background suppression
- 25 ... 300 mm
- pulsed red laser diode
- PNP
- mechanical, 8 turn
- connector M12 4 pin
- -10 ... 50 °C
- IP 67



Picture similar



### Technical data

General data		Electrical data	
Type	Background suppression	Current consumption max. (no load)	35 mA
Light source	Pulsed red laser diode	Current consumption typ.	25 mA
Sensing distance Tw	25 ... 300 mm	Voltage drop Vd	< 2 VDC
Sensing range Tb (at Tw max.)	40 ... 300 mm	Output function	Light / dark operate
Sensing range Tb (at Tw min.)	5 ... 25 mm	Output circuit	PNP
Repeat accuracy	< 0,1 mm at laser focus	Output current	< 200 mA
Output indicator	LED yellow	Short circuit protection	Yes
Sensing distance adjustment	Mechanical, 8 turn	Reverse polarity protection	Yes
Laser class	2	Mechanical data	
Distance to focus	80 mm	Width / diameter	15,4 mm
Wave length	650 nm	Height / length	50 mm
Suppression of reciprocal influence	Yes	Depth	50 mm
Electrical data		Type	Rectangular
Response time / release time	< 0,6 ms	Housing material	Die-cast zinc
Voltage supply range +Vs	10 ... 30 VDC	Front (optics)	Glass
		Connection types	Connector M12 4 pin
		Ambient conditions	
		Operating temperature	-10 ... +50 °C
		Protection class	IP 67

# OHDM 16P5001/S14

Diffuse sensors with background suppression - standard

Article number: 10236806

## Dimension drawing

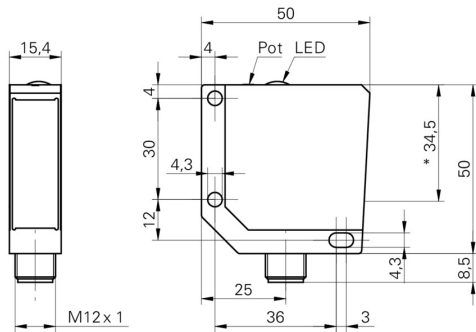

## Connection diagram

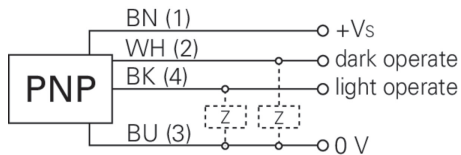

## Laser warning



**LASER RADIATION**  
**DO NOT STARE INTO BEAM**  
Wavelength: 640...670nm  
IEC 60825-1, Ed. 3, 2014  
**CLASS 2 LASER PRODUCT**

IEC 60825-1/2014 Complies with 21 CFR 1040.10 and 1040.11 except for conformance with IEC 60825-1 Ed. 3., as described in Laser Notice No. 56, dated May 8, 2019

## Beam characteristic (typically)

